



PUBLIC WORKS DEPT.

TRAFFIC ENGINEERING AND SPEED MAP
SPEED ZONE SURVEY

ROAD NAME:
AUTOMALL DRIVE

STRIP MAP

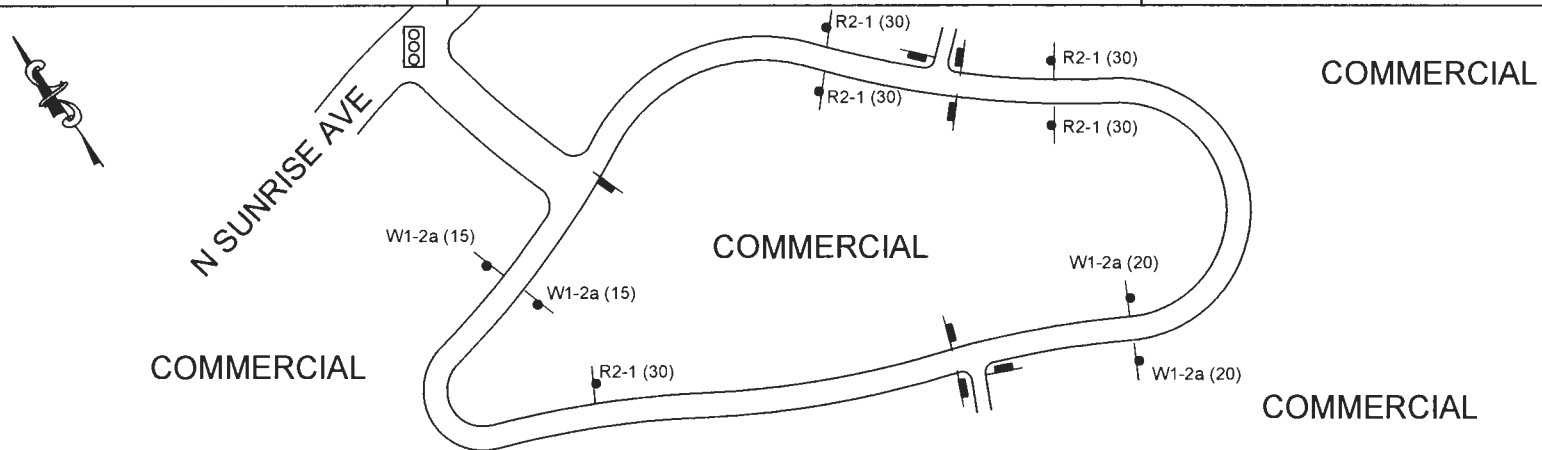

ROADWAY WIDTH	40'
NO. OF LANES	3 (ONE WAY)
ADT	3318
DIVIDER TYPE	NONE
CRITICAL SPEED (85th %)	34.4 MPH
PACE SPEED	22-31 MPH
3-YEAR ACCIDENT HISTORY	5
EXISTING SPEED LIMIT	30 MPH
RECOM. SPEED LIMIT	30 MPH
SEGMENT LENGTH	.87 MI.

LEGEND	STOP SIGNS	SPEED LIMIT SIGN	TRAFFIC SIGNAL
--------	------------	------------------	----------------

MPH	61-75	0	ROADSIDE COND. SCHOOL <input type="checkbox"/> RESIDENCE <input type="checkbox"/> BUSINESS <input checked="" type="checkbox"/> PARKS <input type="checkbox"/> OPEN SPACE <input type="checkbox"/> BIKEWAY <input type="checkbox"/>
	51-60	0	
	41-50	2	
	31-40	34	
	1-30	64	

COMMENTS: NO PARKING ON BOTH SIDES OF STREET.

SOME RECOVERY AREA NO RECOVERY AREA
SCHOOL ROUTE

City of Roseville Engineering and Traffic Survey Summary

Street: AUTOMALL DR
Limits: SUNRISE AV
SUNRISE AV (CIRCULAR ROAD)

Field Observer R. YAKIMCHUK/T.
Checked By: J CERVANTES
Date: 6/19/2019

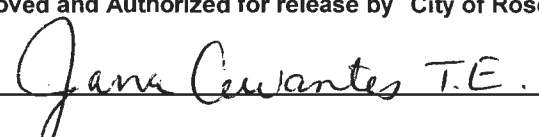
Factors	Direction: <u>North</u>
<u>A. Prevailing Speed Data</u>	
Location of Survey	ACROSS FROM NIELLO
85th Percentile	34.4
10 mph Pace	22 - 31
Percent in Pace	64.0%
Posted Speed Limit	30
<u>B. Collision History</u>	
Date Range Covered	11/1/2015 To 10/31/2018 (3 YEARS.)
Total Collisions	5
Collision Rate (Acc/MVM)	1.561
Expected Collision Rate	1.85
<u>C. Traffic Factors</u>	
Average Daily Traffic	3318
Length of Segment	4650
Lane Configuration	3 LANES IN ONE DIRECTION
Street Classification	Collector
<u>D. Conditions Not Readily Apparent</u>	
Conditions	See: Roadside Conditions on the Speed Zone Survey Map
Roadway Geometrics	Horizontal Curve
Comments	MULTIPLE COMMERCIAL DRIVEWAYS; SLOW VEHICLES; CAR CARRIERS UNLOADING
<u>E. Adjacent Land Use</u>	
	Commercial
Posted Speed Limit	30
Speed Limit Change?	No
Revised Speed Limit	
Approved and Authorized for release by City of Roseville Traffic Engineering Department:	
 _____	<u>8-15-19</u> Date
	Loc. #

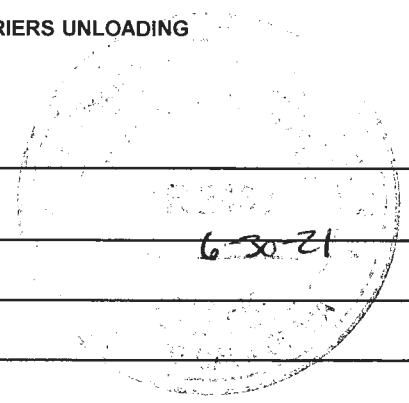

**City of Roseville
Traffic Engineering Department**

Street Name AUTOMALL DR
Limits: SUNRISE AV to SUNRISE AV (CIRCULAR ROAD)

Radar Survey Sheet

X=North /=South

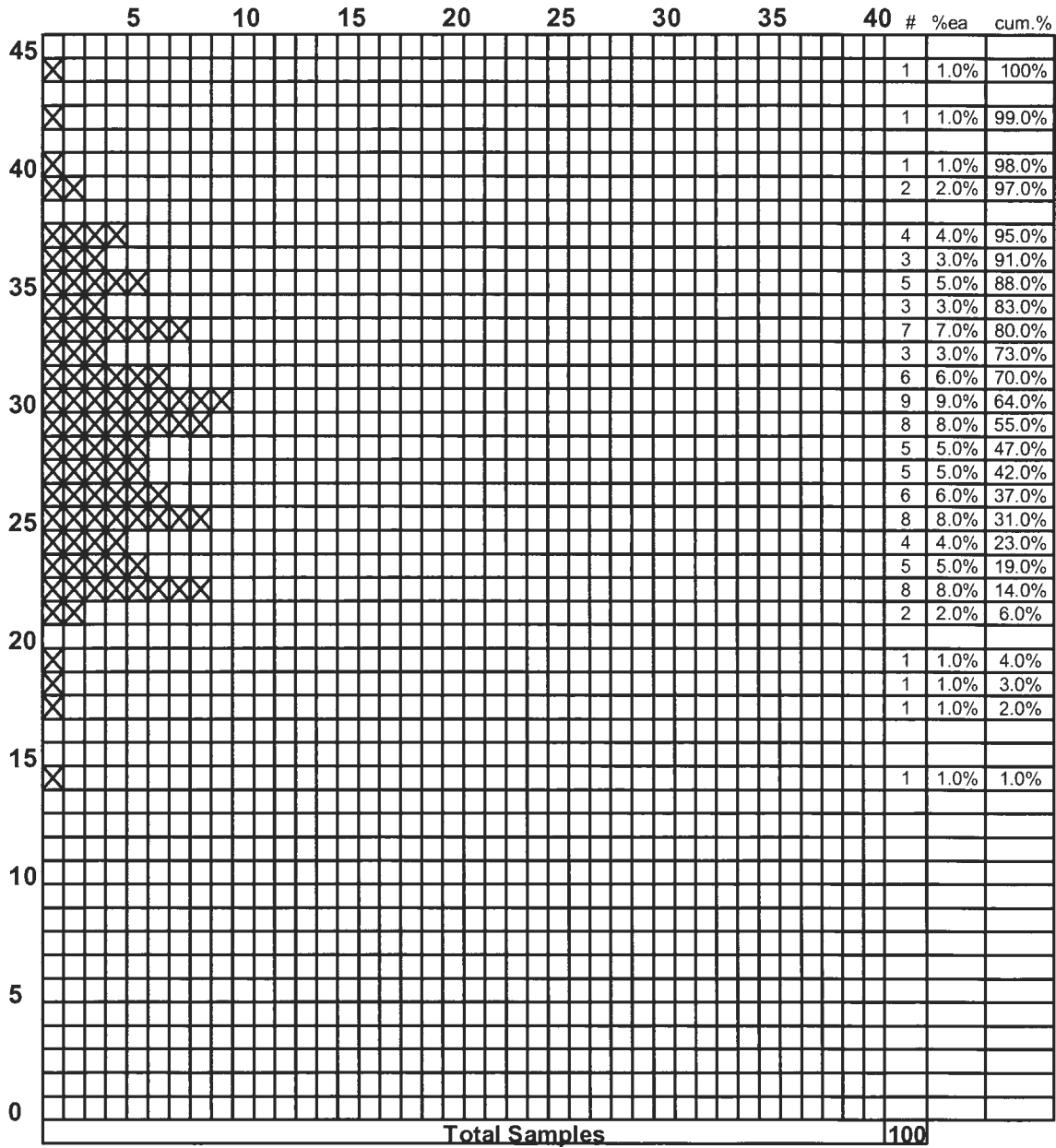

85th Percentile Speed: 34.4
50th Percentile Speed: 28.4
15th Percentile Speed: 22.2
10 MPH Pace: 22- 31
Number in Pace: 64
Percent in Pace: 64.0%

Date of Survey: 6/19/2019 Start Time: 9:00
Weather: Clear End Time: 9:15
Road Condition Good Posted Speed: 30
Street Class.: Collector
Observer R. YAKIMCHUK/T. PHILIP
Conditions not Apparent: See: Roadside Conditions on the Speed Zone Survey Map

**City of Roseville
Traffic Engineering Department**

Lidar Speed Data Worksheet

Date: June 19, 2019 Location # _____

Street Name: Automall Drive Observer: _____

Limits: Nicello Acura to Toyota Roseville Location of Survey: _____

Weather: Sunny Roadway Geometrics: _____

Road Cond: _____ Conditions Not Apparent: _____

Posted Speed: 30mph Start Time: 9:00am

Lane Config: _____ End Time: 9:15am

Adjacent Land Use: _____

Street Classification: Arterial - Collector - Local Collision Start Date: _____

Average Daily Traffic: _____ Collision End Date: _____

Segment Length: _____ Collision Period: _____

Speed Limit Changed? Yes - No Total Collisions: _____

Revised Limit: _____ Collision Rate: _____

Checked By: _____ Expected Collision Rate: _____

Direction: _____

Direction: _____

1. <u>28</u>	21. <u>23</u>	41. <u>26</u>	61. <u>33</u>	81. <u>40</u>	1. _____	21. _____	41. _____	61. _____	81. _____
2. <u>26</u>	22. <u>22</u>	42. <u>25</u>	62. <u>29</u>	82. <u>29</u>	2. _____	22. _____	42. _____	62. _____	82. _____
3. <u>24</u>	23. <u>21</u>	43. <u>26</u>	63. <u>34</u>	83. <u>35</u>	3. _____	23. _____	43. _____	63. _____	83. _____
4. <u>33</u>	24. <u>28</u>	44. <u>33</u>	64. <u>18</u>	84. <u>29</u>	4. _____	24. _____	44. _____	64. _____	84. _____
5. <u>24</u>	25. <u>19</u>	45. <u>26</u>	65. <u>28</u>	85. <u>22</u>	5. _____	25. _____	45. _____	65. _____	85. _____
6. <u>25</u>	26. <u>27</u>	46. <u>39</u>	66. <u>33</u>	86. <u>27</u>	6. _____	26. _____	46. _____	66. _____	86. _____
7. <u>17</u>	27. <u>30</u>	47. <u>28</u>	67. <u>28</u>	87. <u>22</u>	7. _____	27. _____	47. _____	67. _____	87. _____
8. <u>14</u>	28. <u>31</u>	48. <u>22</u>	68. <u>32</u>	88. <u>25</u>	8. _____	28. _____	48. _____	68. _____	88. _____
9. <u>31</u>	29. <u>32</u>	49. <u>37</u>	69. <u>32</u>	89. <u>37</u>	9. _____	29. _____	49. _____	69. _____	89. _____
10. <u>23</u>	30. <u>36</u>	50. <u>30</u>	70. <u>39</u>	90. <u>31</u>	10. _____	30. _____	50. _____	70. _____	90. _____
11. <u>21</u>	31. <u>34</u>	51. <u>29</u>	71. <u>30</u>	91. <u>33</u>	11. _____	31. _____	51. _____	71. _____	91. _____
12. <u>23</u>	32. <u>26</u>	52. <u>25</u>	72. <u>30</u>	92. <u>31</u>	12. _____	32. _____	52. _____	72. _____	92. _____
13. <u>25</u>	33. <u>30</u>	53. <u>33</u>	73. <u>22</u>	93. <u>42</u>	13. _____	33. _____	53. _____	73. _____	93. _____
14. <u>29</u>	34. <u>36</u>	54. <u>29</u>	74. <u>25</u>	94. <u>24</u>	14. _____	34. _____	54. _____	74. _____	94. _____
15. <u>29</u>	35. <u>35</u>	55. <u>31</u>	75. <u>44</u>	95. <u>35</u>	15. _____	35. _____	55. _____	75. _____	95. _____
16. <u>30</u>	36. <u>22</u>	56. <u>34</u>	76. <u>37</u>	96. <u>26</u>	16. _____	36. _____	56. _____	76. _____	96. _____
17. <u>27</u>	37. <u>13</u>	57. <u>33</u>	77. <u>29</u>	97. <u>25</u>	17. _____	37. _____	57. _____	77. _____	97. _____
18. <u>35</u>	38. <u>35</u>	58. <u>30</u>	78. <u>31</u>	98. <u>22</u>	18. _____	38. _____	58. _____	78. _____	98. _____
19. <u>36</u>	39. <u>13</u>	59. <u>30</u>	79. <u>24</u>	99. <u>25</u>	19. _____	39. _____	59. _____	79. _____	99. _____
20. <u>37</u>	40. <u>27</u>	60. <u>27</u>	80. <u>30</u>	100. <u>22</u>	20. _____	40. _____	60. _____	80. _____	100. _____

Comments: